

USA
TRUCK BODYTM
WWW.USTRUCKBODY.COM



FRP VAN BODY

BODIES HIGHER
HELD TO A STANDARD

U.S. Truck Body offers dry freight van body solutions that give our customers a competitive advantage. Our bodies are built around customer needs and able to withstand the most demanding conditions, at the lowest total cost of ownership.

Our FRP Body is an alternate construction method that has some unique advantages when compared to a standard aluminum body. FRP construction results in an extremely durable and rigid construction, along with additional space due to the absence of wall posts.

FIBERGLASS REINFORCED PLYWOOD

FRP is an extremely durable panel that is constructed of plywood, reinforced with fiberglass, and then gel coated. 5/8" plywood core is our standard size, however multiple thicknesses are available to fit your application.



ADVANTAGES

- Strongest body construction available
- Smooth exterior that's great for graphic applications
- Brighter interior with white walls
- Dent resistant
- Additional cubic feet over aluminum sheet and post
- Non-corrosive
- Easy to clean



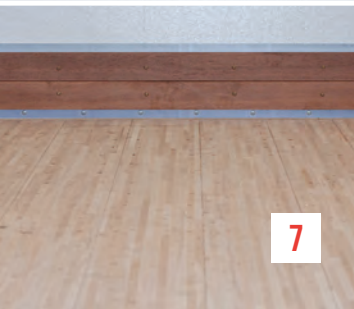
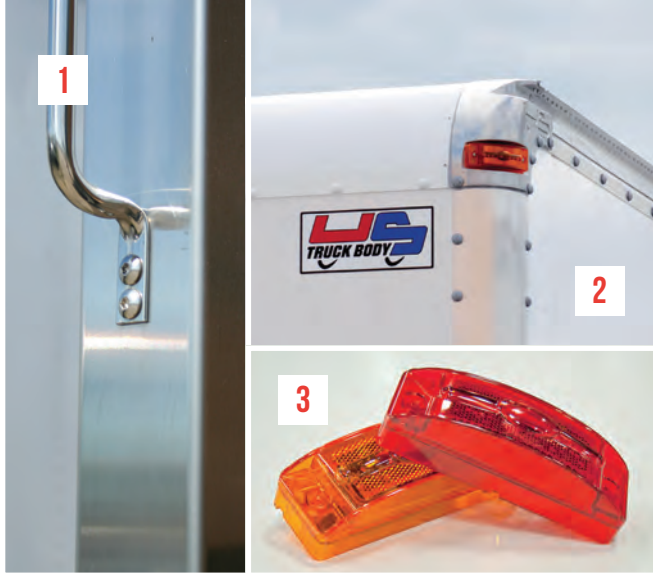

We are dedicated to customer needs and feedback, which has driven design improvements over the years.

From our manufacturing process to our materials, ordinary areas of vulnerability are now strengths.

1. Stainless Steel Rear Frame

A 12 gauge stainless steel rear frame comes standard. All corners are internally reinforced for strength, as well as externally gusseted at the top corners. This frame will look good throughout the life of the body, without having to worry about chipping paint or corrosion.

2. One Of A Kind Roof

Our unique two-piece roof-rail design not only increases strength, it also allows for an easy replacement (if damaged) without disturbing the front, sides, and rear structure. Durable, aluminum castings on each corner increase strength while the front "zephyr" improves aerodynamics. Aluminum or translucent available.

3. LED Clearance Lights

Brighter, longer lasting LED clearance lights are standard and FMVSS-108 compliant. LED tail lights are also used with the recessed taillight option.

4. DuraPlate® Swing Doors

Our side and rear swing doors are an industry benchmark. We custom build each door using 13mm thick DuraPlate® panels exclusively for durability. Stainless steel bar lock hardware, aluminum hinges, and replaceable stainless steel pins are installed creating an extremely strong door that's corrosion resistant.

5. Corrosion Resistant Hardware

The swing doors are not the only part of the truck body with corrosion resistant hardware – the exterior is assembled using only aluminum and stainless fasteners.

6. Superior Strength Front Wall

Extruded aluminum radius corners with 5/8" core FRP make our front walls extremely durable. When scuff plate is options, we extend it below the floor and weld to the understructure to withstand even the toughest abuse.

7. Domestic Hardwood Floors

We use only 1-1/8" or thicker laminated domestic hardwood, which runs the full length of the body, to ensure durability. No need to worry about delamination or warping down the road.

8. Weatherproof Undercoating

To protect from the harsh environment, after the body is mounted and wired, a weatherproof undercoating is applied to seal the interior and protect the underside.

U.S. TRUCK BODY ADVANTAGES

QUICK RESPONSE ON QUOTES

Same day or always within 24 hours. Call 800-433-0843 or fill out our convenient form online at www.ustruckbody.com.

PERSONAL SALES SUPPORT

An internal sales consultant tracks daily production to keep you better informed of your truck body order.

FLEXIBILITY

Need something custom? We build to order and are ready to build exactly what you need.

STANDARD LENGTH (INSIDE) 10' - 28'

(Outside length is 6 3/8" longer than inside dimension)

Custom sizes available.

SHORT LEAD TIMES

We work hard to keep short lead times and meet tight deadlines. Whether it's completely custom or a stock body, you can expect a quick turnaround.

PREMIUM QUALITY

We use the best materials, optimal manufacturing practices, along with our 60+ years of experience and highly trained workers.



STANDARD WIDTH AND HEIGHT

MODEL #	INSIDE		OUTSIDE		REAR DOOR OPENING	
	Width	Height	Width	Height	Width	Height
VA-78	94.5"	78"	96"	85"	88"	72 - 1/2"
VA-84	94.5"	84"	96"	91"	88"	78 - 1/2"
VA-90	94.5"	90"	96"	97"	88"	84 - 1/2"
VA-96	94.5"	96"	96"	103"	88"	90 - 1/2"
VA-102	94.5"	102"	96"	109"	88"	96 - 1/2"
VA-108	94.5"	108"	96"	115"	88"	102 - 1/2"

Notes: A. Inside length measured from inside front FRP panel to inside surface of roll-up rear door.
B. For full rear swing-type doors, add 3 1/2" to inside body length.
C. Inside width is measured from panel to panel. Add 6" for 102" O.D.
D. Outside height of body is measured excluding longitudinals.
E. Rear door openings are same for roll-up or swing type doors.